



We want to personally thank you for becoming part of the Sirena family. Satisfaction with your new Sirena is our priority. We're confident that your Sirena will provide you with many years of healthier cleaning!

Team Sirena

#### • Sirena Warranty

When used and maintained, in accordance with Sirena owner's instructions, the Sirena vacuum has a warranty (to the original purchaser) against defects in material and workmanship for a period of 10 years on the Sirena main unit motor, 3 years on power nozzle motor and all other parts, and 1 year for labor, from the date of purchase. This warranty applies to product for indoor personal use only. Work will only be considered for warranty if your Sirena is registered with the manufacturer or you have the original bill of sale. Any tampering with your Sirena will void any warranty claims. All work must be carried out by a factory authorized Sirena dealer. When you purchase through an online distribution channel or an authorized distributor who does not provide service, you may locate a Sirena authorized dealer online through our website or you may contact Sirena directly.

#### What is not covered?

This warranty does not apply to routine maintenance parts such as (but not limited to) belts, clips, wheels and brushes. Damage as a result of negligence, misuse, abuse or unauthorized repair is not covered. For service please see your authorized Sirena dealer. This warranty is exclusive and in lieu of any other warranties either oral or written, any implied warranties which may arise by operation of law, including warranties of merchantability or fitness for a particular purpose, are disclaimed. In no event will Sirena Inc be liable for any special, indirect, incidental or consequential damages of any kind or nature to owner or any party claiming through owner, whether based in contract, negligence, tort or strict products liability or arising from any cause whatsoever.

[www.sirenainc.com](http://www.sirenainc.com)

Team Sirena 1-855-4SIRENA (1-855-477-3662)  
15459 Carleton Rd., Ottawa, ON Canada K1J 9M3

### Warranty Registration

Please mail in this registration or complete online at [www.sirenainc.com](http://www.sirenainc.com)

First name:	Last name:
Address:	Apt./Suite:
City:	State/Prov:
Zip/Postal:	Country:
Daytime Phone: ( )	Evening Phone: ( )
Email:	Source: Retail Store
	TV
Date of Purchase: / /	Online
Name of Store:	Other (Details)
Sirena serial #	Store City:
	Power Nozzle serial #



OTTAWA, ONTARIO CANADA



Sirena  
TOTAL HOME CLEANING SYSTEM

INSTRUCTION MANUAL



Canadian designed & engineered Italian technology motor technology  
[www.sirenainc.com](http://www.sirenainc.com)

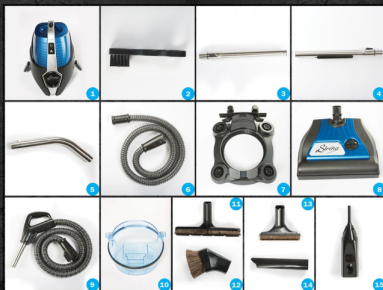
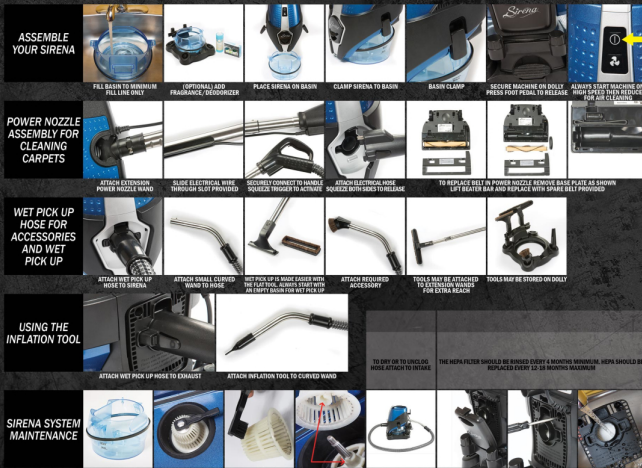

**IMPORTANT! PLEASE READ ALL SAFETY INSTRUCTIONS BEFORE ATTEMPTING TO USE YOUR SIRENA SYSTEM.**

- DO NOT USE TO PICK UP FLAMMABLE OR COMBUSTIBLE LIQUIDS SUCH AS GASOLINE, OR USE IN AREAS WHERE THEY MAY BE PRESENT. DO NOT USE IN THE PRESENCE OF FLAMMABLE VAPORS OR DUST.
- DO NOT USE YOUR SIRENA WITHOUT WATER IN THE BASIN, EXCEPT FOR WET PICK UP.
- DO NOT STORE YOUR SIRENA ON THE BASIN WHEN NOT IN USE.
- DO NOT USE ELECTRIC HOSE FOR WET PICK UP.
- DO NOT USE YOUR SIRENA TO PICK UP NON-WATER SOLUBLE MATERIALS SUCH AS (BUT NOT LIMITED TO) DRYWALL DUST, SAWDUST OR FLOUR.
- DO NOT FILL BASIN BELOW MINIMUM FILL LINE, OR ABOVE MAXIMUM FILL LINE.
- DO NOT PULL ON CORD FOR ANY REASON. DO NOT USE CORD AS A HANDLE.
- DO NOT RUN OVER CORD OR ALLOW CORD TO REST ON HEATED SURFACES.

**BOX CONTENTS:**

- SIRENA SYSTEM
- SEPARATOR BRUSH/TOOL
- EXTENSION WAND
- EXTENSION WAND (ELECTRIC)
- CURVED WAND
- WET PICK UP HOSE
- DOLLY
- POWER NOZZLE
- ELECTRIFIED HOSE
- BASIN
- FLOOR BRUSH
- DUSTING BRUSH
- UPHOLSTERY BRUSH
- CREVICE TOOL
- INFLATION TOOL

**IMPORTANT SAFETY INSTRUCTIONS PLEASE READ BEFORE USING YOUR SIRENA.**

When using an electrical appliance, basic precautions should be followed, including the following:

**WARNING:** This product is intended for normal household use only. Manufacturer cannot accept responsibility for damage caused by improper use of the machine. THIS APPLIANCE USES A POLARIZED PLUG WHICH IS ONLY DESIGNED TO BE INSERTED ONE WAY. DO NOT ATTEMPT TO OVERRIDE THIS SAFETY FEATURE.

**To reduce the risk of electrical shock or injury:**

- Do not leave Sirena unattended while plugged in, always unplug before servicing or attempting to remove any blockages.
- ELECTRICAL SHOCK COULD OCCUR IF USED OUTDOORS OR ON WET SURFACES.
- Do not handle plug or appliance with wet hands.
- Do not allow children to operate Sirena.
- Use only as described in this manual and only with manufacturer approved accessories.
- Do not use with a damaged cord or plug, or if the unit has been dropped or left outside.
- DO NOT PULL ON CORD FOR ANY REASON. DO NOT USE CORD AS A HANDLE. DO NOT RUN OVER CORD OR ALLOW CORD TO REST ON HEATED SURFACES.
- Do not put any objects into openings. Do not use with any openings blocked (keep hair, loose clothing, fingers and all body parts away from openings and moving parts).
- Do not use to pick up flammable or combustible liquids such as gasoline, or use in areas where they may be present. Do not use in the presence of flammable vapors or dust.
- Do not pick up anything that is burning or smoking such as cigarettes, matches or hot ashes.
- Do not pick up non water soluble products such as drywall dust, flour etc.
- Use extra care when cleaning stairs.
- The electrical hose contains electrical wires. Do not use the electric hose for wet pick up or if hose is damaged, cut or punctured. DO NOT pick up sharp objects.

**YOUR SIRENA IS DESIGNED TO OPERATE ONLY WITH BASIN ATTACHED. THIS IS A SAFETY FEATURE. DO NOT ATTEMPT TO OVERRIDE THIS SAFETY FEATURE. NEVER OPERATE YOUR SIRENA WITHOUT WATER IN THE BASIN, EXCEPT WHEN USING FOR WET PICK UP. NEVER FILL BASIN ABOVE MAXIMUM FILL LINE. NEVER STORE SIRENA ON BASIN WHEN NOT IN USE. ONLY USE THE NON-ELECTRIC HOSE FOR WET PICK UP.**

Record serial numbers here for your records.

Sirena #   
Power nozzle #

KEEP THESE INSTRUCTIONS FOR FUTURE REFERENCE



**TROUBLESHOOTING GUIDE**

ISSUE	POSSIBLE SOLUTION
SIRENA WILL NOT START	CHECK POWER CORD IS CORRECTLY INSERTED AND OUTLET IS WORKING. MAKE SURE YOUR SIRENA IS CORRECTLY INSERTED ON THE BASIN. IT SHALL NOT RUN IF NOT CORRECTLY INSERTED.
SIRENA IS NOT STARTING ON LOW SPEED	YOU MUST ALWAYS START THE MACHINE ON HIGH SPEED FIRST, AND THEN CHANGE TO LOW SPEED TO CLEAN THE AIR. THERE IS A 4 SECOND DELAY WHEN CHANGING TO LOW SPEED.
SIRENA IS NOT PICKING UP DIRT	CLEAN THE SEPARATOR. CHANGE WATER IN BASIN. CHECK HOSES AND POWER NOZZLE FOR TANGLES, KNOTS OR CLOGGING. RINSE OR REPLACE HEPA.
POWER NOZZLE WILL NOT TURN	CHECK BRUSH FOR TANGLES AND/OR OBSTRUCTIONS. MAKE SURE ALL CONNECTIONS ARE SECURE. CHECK THAT BELT IS PROPERLY ATTACHED.
BAD SMELL IN EXHAUST	RINSE AND CLEAN THE BASIN, SEPARATOR AND HEPA FILTER. CHECK AND REMOVE ANY OBSTRUCTIONS IN HOSES AND TOOLS.
SIRENA SHAKES WHEN RUNNING	BASIN IS OVER FILLED. EMPTY AND REFILL. CLEAN THE SEPARATOR. POSSIBLY A FLAMMABLE AGENT IN WATER. EMPTY BASIN AND WASH THOROUGHLY.
SIRENA SHUTS OFF BY ITSELF	YOUR MOTOR IS PROTECTED BY AN AUTOMATIC SHUT OFF IN CASE OF OVERHEATING. LEAVE MACHINE OFF UNTIL COOL ENOUGH TO COOL AND TRY AGAIN.
CLOGGED HOSE	REMOVE HEPA COVER. INSERT CLOGGED HOSE IN FORWARD AND TURNING IN INWARD. TURN ON MACHINE. TO REMOVE CLOG.

SHOULD THESE SOLUTIONS NOT WORK BRING YOUR SIRENA TO AN AUTHORIZED SIRENA REPAIR LOCATION.